

82P50-800

Pneumatic Pin Clamp | Tolerance Compensation | Ordering Information

82P50-800 **L10** **A** **01** **00** **0**

Base Model	Description
82P50-800	Tolerance Compensation 0 - 5 mm [0 - 0.197 in]

Blanks	Description
A	Flat Blanks

Finger Direction	Description
0	Two Fingers Standard Direction
1	Two Fingers Perpendicular to Standard Direction



Sensor	Description
L10	PNP Sensor with M12x1 Cable Connector (8EA-158-4 and 8EA-163-4)

Centering Pin Size	Ø Range
01	15,8 -0,05 mm
02	19,8 -0,05 mm
03	20,3 -0,05 mm
04	29,8 -0,05 mm

Pin Shape	Description
00	Standard
01*	Pin Clipping
02*	Pin Release on Flat Perpendicular of Finger
03*	Pin Release on Flat Parallel of Finger

*Pin Clipping/Release Dimension X
Ø15,8 = 14,5 mm
Ø19,8 = 18,0 mm
Ø20,3 = 18,0 mm
Ø29,8 = 27,5 (Pin Shape 01, 02)
Ø29,8 = 25,0 (Pin Shape 03)

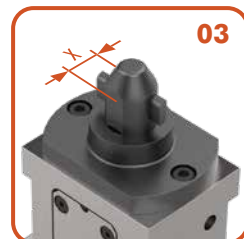
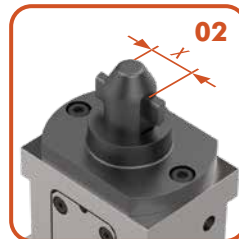
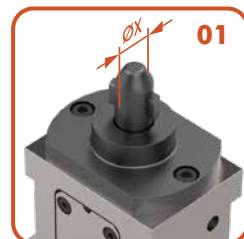

82P50-8

Pneumatic Pin Package | Tolerance Compensation | Dimensions and Technical Specifications

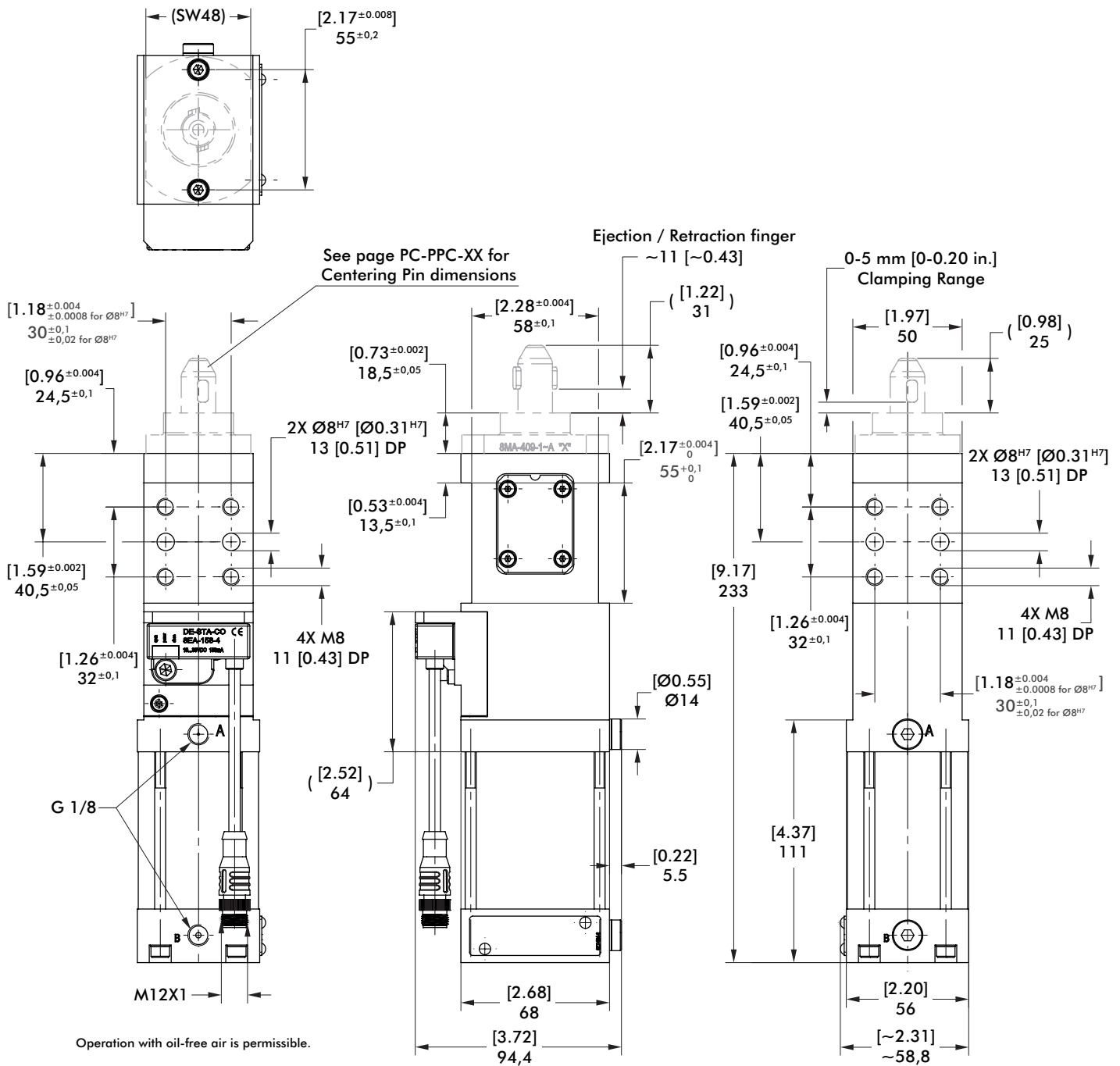

Specification	Unit	82P50-800
Max. Clamping Force @ 5 bar	[lbf] N	[124] 550
Max. Operating Pressure	[psi] bar	[87] 6
Actuation Time: Open	sec	0.3
Close	sec	0.3
Air Consumption per Double Stroke @ 6 bar [87psi]	[in ³] liter	[42.72] 0,7
Weight	[lb] kg	[5.73] 2,6

82P50-800 CENTERING PINS

Pneumatic Pin Package | Tolerance Compensation | Dimensions and Technical Specifications

00 Standard Pin

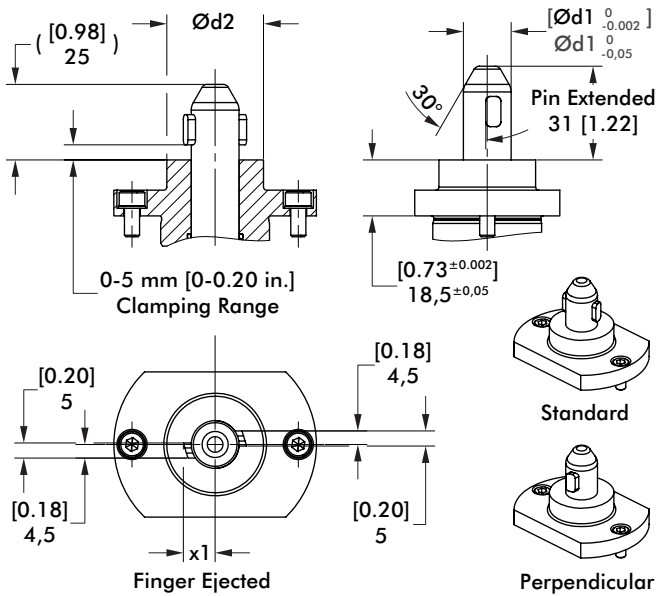

Pin Size	Ød1	Ød2	x1
01	15.8 [0.62]		10.4 [0.41]
02	19.8 [0.78]	32 [1.26]	15.8 [0.62]
03	20.3 [0.80]		
04	29.8 [1.17]	48 [1.89]	20.6 [0.81]

01 Pin Clipping

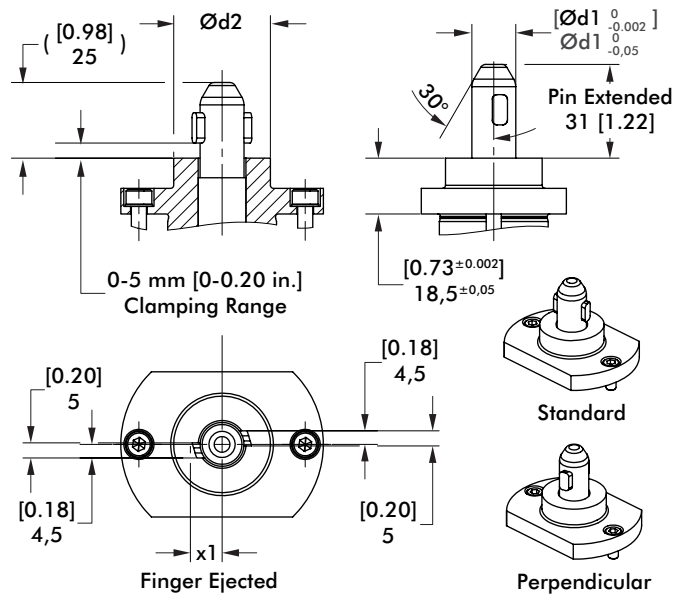

Pin Size	Ød1	Ød2	x1
00	14,5 [0.57]		10,4 [0.41]
01	18 [0.71]	32 [1.26]	14,9 [0.59]
02			
03	27,5 [1.08]	48 [1.89]	19,5 [0.77]

02 Pin Release on Flat Perpendicular of Finger

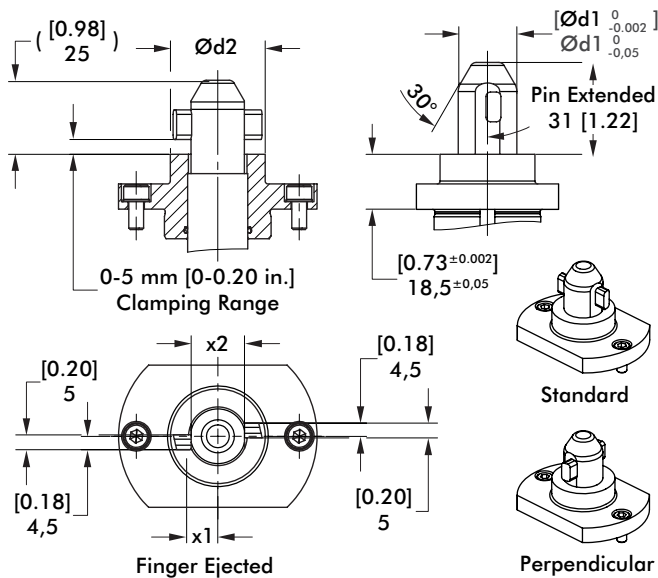

Pin Size	Ød1	Ød2	x1	x2
00	15.8 [0.62]		10.4 [0.41]	14.5 [0.57]
01	19.8 [0.78]	32 [1.26]	14,9 [0.59]	18 [0.71]
02	20.3 [0.80]			
03	29.8 [1.17]	48 [1.89]	19,5 [0.77]	27.5 [1.08]

03 Pin Release on Flat Parallel of Finger

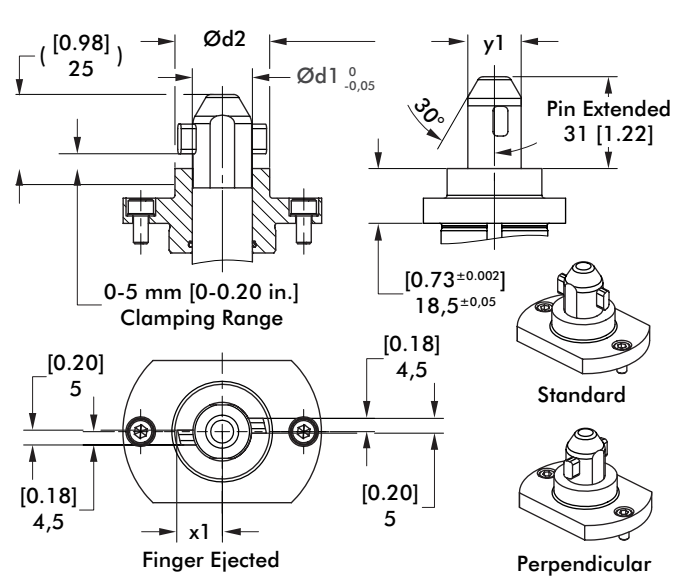

Pin Size	Ød1	Ød2	x1	y1
00	15.8 [0.62]		10,4 [0.41]	14.5 [0.57]
01	19.8 [0.78]	32 [1.26]	15.8 [0.62]	18 [0.71]
02	20.3 [0.80]			
03	29.8 [1.17]	48 [1.89]	20.6 [0.81]	25 [0.98]

Pneumatic Pin Package | Tolerance Compensation | Dimensions and Technical Specifications

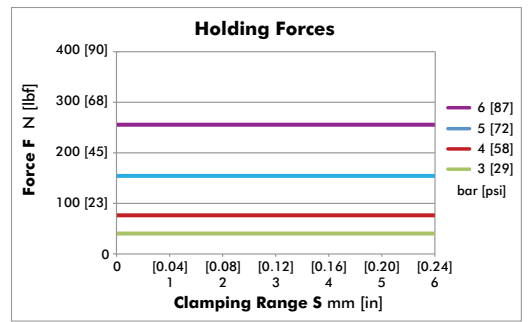
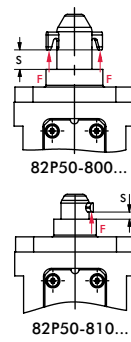
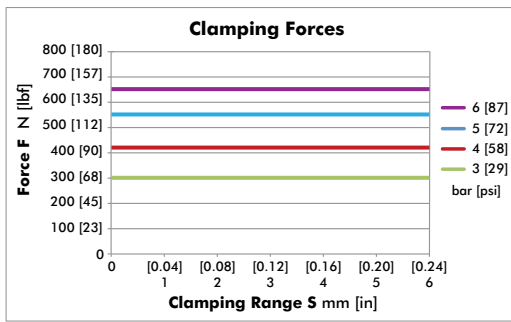
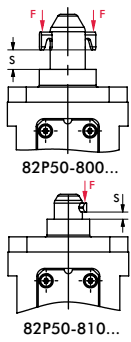

Max Deviation for Centering Pin

Model no.	Position	Shear Force F N [lbf]	Deviation ± mm [in]
82P50-800	Open	100 [23]	0,032 [0.0013]
	Closed		0,023 [0.0009]

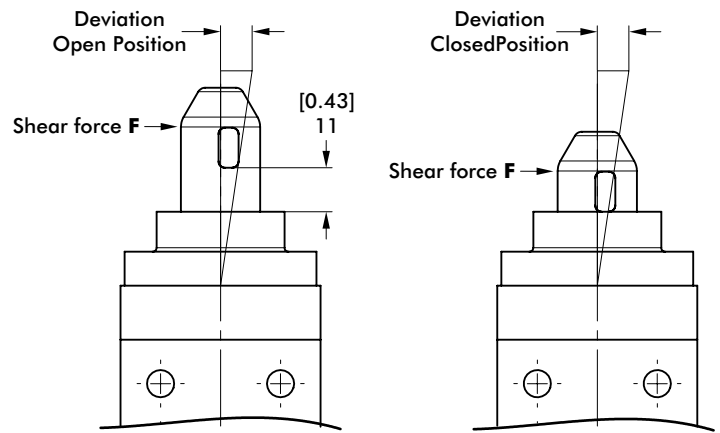

Inductive Sensor Wiring Diagram

Sensing system immune to interference from AC / DC arc welding.

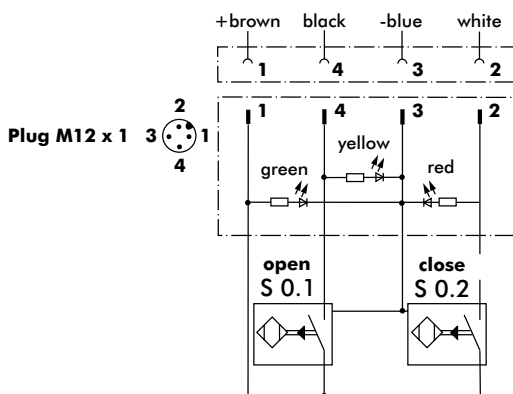

Sensor Cable Accessories

Sensor Cables (1 connector & 5m cable)	Order no.
M12x1 connector, straight, 5-pin	8EL-002-1
M12x1 connector, 90° angular, 4-pin	8EL-003-1

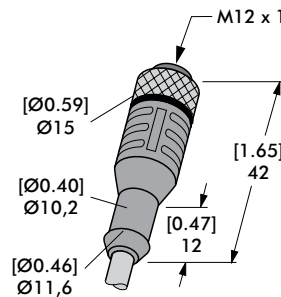

Straight Cable
8EL-002-1

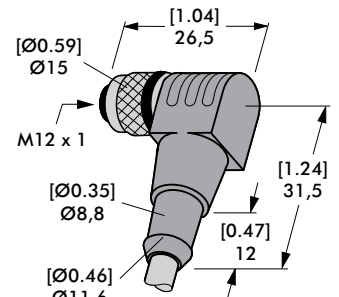

Angular Cable
8EL-003-1